

Verkehrszeichenplan

- => Sperrung der Straße "Ekeler Weg" (inkl. einseitig des Gehweges)
- => mit fortführender Umleitungsbeschilderung
- => einseitig Sackgassenregelung (bis Baustelle frei)
- => Verkehrsregelung durch Verkehrszeichen

Looger Weg

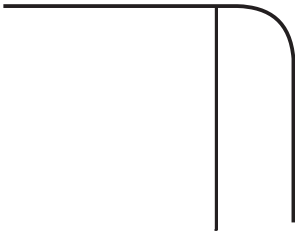

Heitsweg

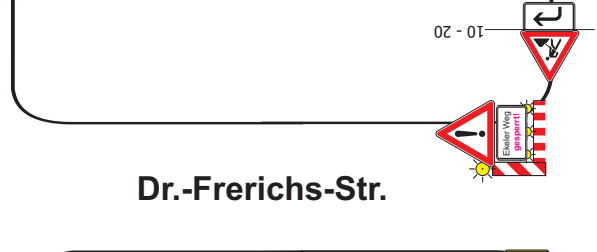
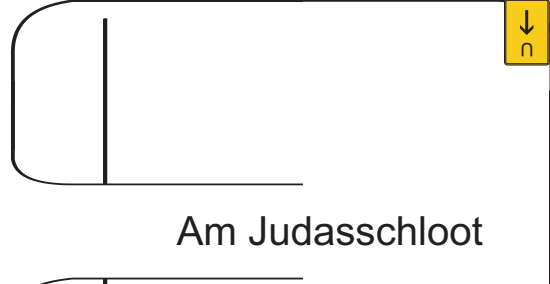
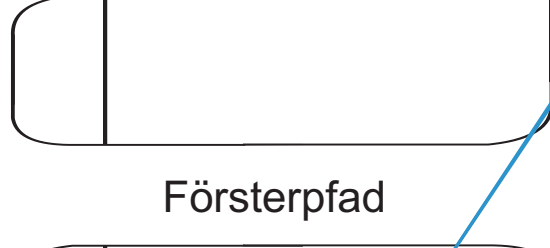
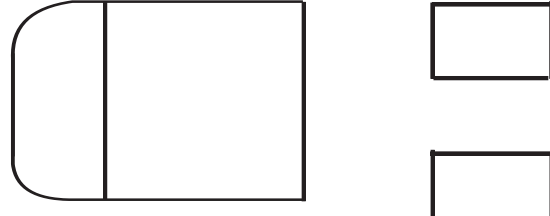
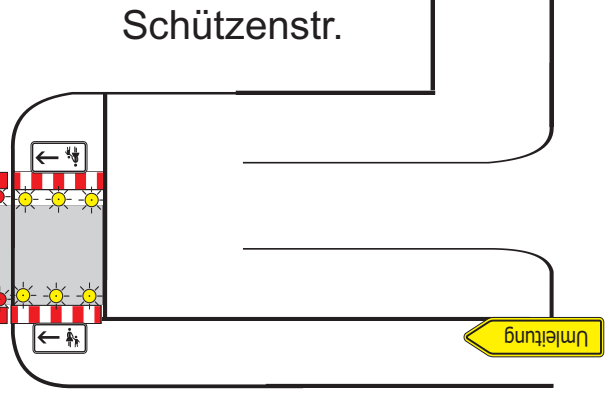
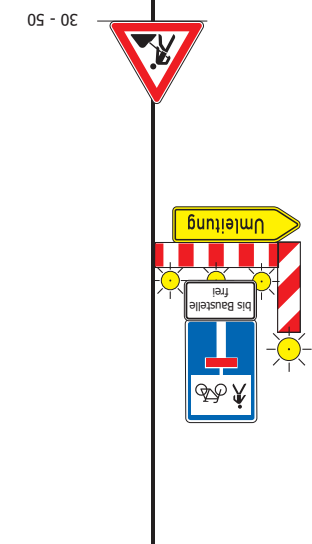
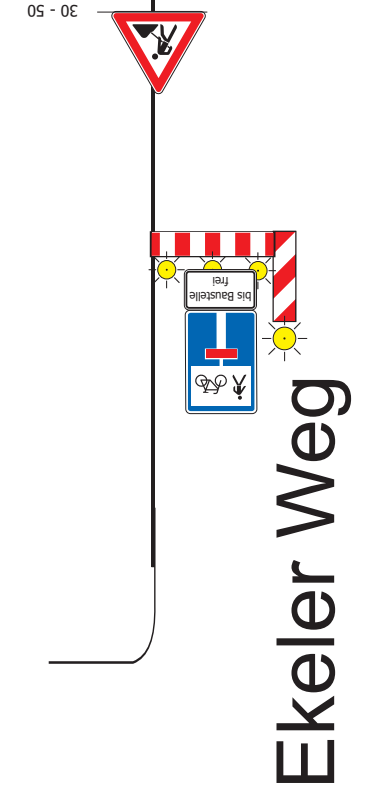
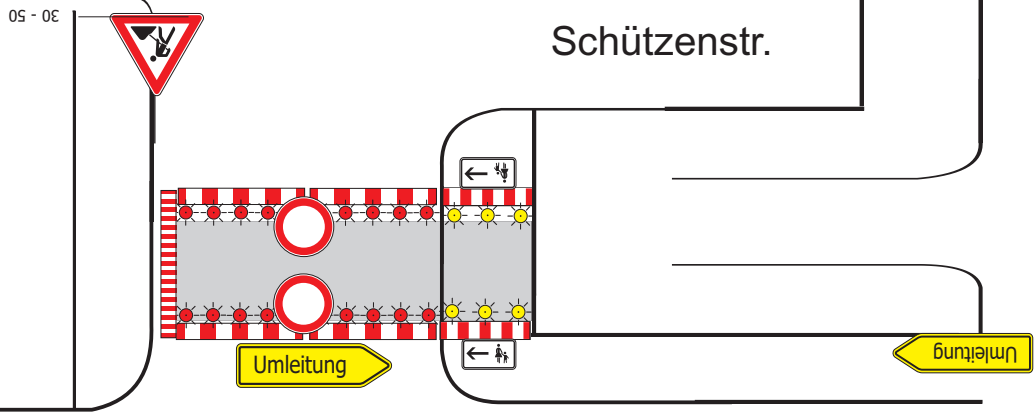
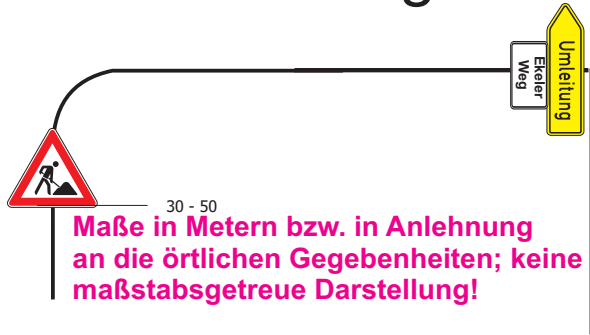

Osterstraße (K 242)



Maße in Metern bzw. in Anlehnung an die örtlichen Gegebenheiten; keine maßstabgetreue Darstellung!